

**TECHNICAL MANUAL**

**GENERAL SUPPORT MAINTENANCE  
REPAIR PARTS AND SPECIAL TOOLS LIST**

**FOR**

**CHARGER, BATTERY PP-2926D/U  
(NSN 6130-01-099-5975)**

**THIS PUBLICATION IS A COURTESY QUICK COPY FROM THE  
UNITED STATES ARMY PUBLICATIONS DISTRIBUTION  
CENTER, ST. LOUIS, MISSOURI, TO MEET YOUR NEEDS  
WHILE WE REPLENISH OUR REGULAR STOCK.**

---

**HEADQUARTERS, DEPARTMENT OF THE ARMY  
4 DECEMBER 1980**

**GENERAL SUPPORT MAINTENANCE  
REPAIR PARTS AND SPECIAL TOOLS LIST  
FOR**

**CHARGER, BATTERY PP-2926D/U  
(NSN 6130-01-5975)**

*Current as of 23 September 1980*

**REPORTING ERRORS AND RECOMMENDING IMPROVEMENTS**

You can help improve this manual. If you find any mistakes or if you know of a way to improve the procedures, please let us know. Mail your letter, DA Form 2028 (Recommended Changes to Publications and Blank Forms), or DA Form 2028-2 located in back of this manual direct to: Commander, US Army Communications and Electronics Materiel Readiness Command, ATTN: DRSELME-MQ, Fort Monmouth, NJ 07703. In either case, a reply will be furnished direct to you.

Table of Content

		Page	Illus Figure
SECTION	I. Introduction.....	1	
	II. Repair parts list.....	6	
GROUP	00 Charger, Battery PP-2926D/U .....	6	1
	01 Printed Circuit Board (AI) .....	9	2
SECTION	III. Special tools list (Not applicable)		
	IV. National stock number and part number index .....	10	

**SECTION I  
INTRODUCTION**

---

**1. Scope**

This manual lists spares and repair parts; special tools; special test, measurement, and diagnostic equipment (TMDE), and other special support equipment required for performance of general support maintenance of the PP-2926D/U. It authorizes the requisitioning and issue of spares and repair parts as indicated by the source and maintenance codes.

**2. General**

This Repair Parts and Special Tools List is divided into the following sections:

a. Section II. Repair Parts List. A list of spares and repair parts authorized for use in the performance of maintenance. The list also includes parts which must be removed for replacement of the authorized parts. Parts lists are composed of functional groups in numeric sequence, with the parts in each group listed in figure and item number sequence.

b. Section III. Special Tools List. Not applicable.

c. Section IV. National Stock Number and Part Number Index. A list, in National item identification number (NIIN) sequence, of all National stock numbers (NSN) appearing in the listings, followed by a list, in alphanumeric sequence, of all part numbers appearing in the listings. National stock numbers and part numbers are cross-referenced to each illustration figure and item number appearance.

**3. Explanation of Columns**

a. Illustration. This column is divided as follows:

- (1) Figure number. Indicates the figure number of the illustration on which the item is shown.
- (2) Item number. The number used to identify item called out in the illustration.

b. Source, Maintenance, and Recoverability (SMR) Codes.

(1) Source code. Source codes indicate the manner of acquiring support items for maintenance, repair, or overhaul of end items. Source codes are entered in the first and second positions of the Uniform SMR Code format as follows:

<i>Code</i>	<i>Definition</i>
PA	-Item procured and stocked for anticipated or known usage.
MD	-Item to be manufactured or fabricated at the depot maintenance level.
XA	-Item is not procured or stocked because the requirements for the item will result in the replacement of the next higher assembly.
XD	-A support item that is not stocked. When required, item will be procured through normal supply channels.

**NOTE**

Cannibalization or salvage may be used as a source of supply for any items source coded above except those coded XA and aircraft support items as restricted by AR 700-42.

(2) Maintenance code. Maintenance codes are assigned to indicate the levels of maintenance authorized to USE and REPAIR support items. The maintenance codes are entered in the third and fourth positions of the Uniform SMR Code format as follows:

(a) The maintenance code entered in the third position will indicate the lowest maintenance level authorized to remove, replace, and use the support item. The maintenance code entered in the third position will indicate one of the following levels of maintenance:

<i>Code</i>	<i>Application/Explanation</i>
O	- Support item is removed, replaced, used at the organizational level.
H	- Support item is removed, replaced, used at the general support level.

(b) The maintenance code entered in the fourth position indicates whether the item is to be repaired and identifies the lowest maintenance

level with the capability to perform complete repair (i.e., all authorized maintenance functions). This position will contain one of the following maintenance codes:

<i>Code</i>	<i>Application/Explanation</i>
H	- The lowest maintenance level capable of complete repair of the support item is the general support level.
Z	- Nonreparable. No repair is authorized. (3) Recoverability code. Recoverability codes are assigned to support items to indicate the disposition action on unserviceable items. The recoverability code is entered in the fifth position of the Uniform SMR Code format as follows:

Recoverability codes Definition

Z	- Nonreparable item. When unserviceable, condemn and dispose at the level indicated in position 3.
H	- Repairable item. When uneconomically repairable, condemn and dispose at the general support level.

c. National Stock Number. Indicates the National stock number assigned to the item and will be used for requisitioning purposes.

d. Part Number. Indicates the primary number used by the manufacturer (individual, company, firm, corporation, or Government activity), which controls the design and characteristics of the item by means of its engineering drawings, specifications, standards, and inspection requirements to identify an item or range of items.

**NOTE**

When a stock numbered item is requisitioned, the repair part received may have a different part number than the part being replaced.

e. Federal Supply Code for Manufacturer (FSCM). The FSCM is a 5-digit numeric code listed in SB 708-42 which is used to identify the manufacturer, distributor, or Government agency, etc.

f. Description. Indicates the Federal item name and, if required, a minimum description to identify the item.

g. Unit of Measure (U/M). Indicates the standard of the basic quantity of the listed item as used in performing the actual maintenance function. This measure is expressed by a two-character alphabetical abbreviation (e.g., ea, in, pr, etc).

When the unit of measure differs from the unit of

issue, the lowest unit of issue that will satisfy the required units of measure will be requisitioned.

h. Quantity Incorporated in Unit. Indicates the quantity of the item used in the breakout shown on the illustration figure, which is prepared for a functional group, subfunctional group, or an assembly.

**4. Special Information**

a. Detailed manufacturing instructions for item source coded to be manufactured or fabricated are found in TM 11-6130-412-14.

b. The following publications pertain to the PP-2926D/U and its components: TM11-6130-412-14, Charger, Battery PP- 2926D/U TM 11-6130-412-20P, Charger, Battery PP- 2926D/U

c. National stock numbers (NSN's) that are missing from P source coded items have been applied for and will be added to this TM by future change/revision when they are entered in the Army Master Data File (AMDF). Until the NSN's are established and published, submit exception requisitions to Commander, US Army Communications and Electronics Materiel Readiness Command, ATTN: DRSEL MM, Fort Monmouth, NJ 07703 for the part required to support your equipment.

**5. How to Locate Repair Parts**

a. When National stock number or part number is unknown.

(1) First. Using the table of contents, determine the functional group within which the item belongs. This is necessary since illustrations are prepared for functional groups and listings are divided into the same groups

(2) Second. Find the illustration covering the functional group to which the item belongs

(3) Third. Identify the item on the illustration and note the illustration figure and item number of the item.

(4) Fourth. Using the Repair Parts Listing, find the figure and item number noted on the illustration.

b. When National stock number or part number is known.

(1) First. Using the Index of National Stock Numbers and Part Numbers, find the pertinent National stock number or part number. This index is in NIIN sequence followed by a list of part numbers in alphameric sequence, cross-referenced to the illustration figure number and item number.

(2) Second. After finding the figure and item number, locate the figure and item number in the repair parts list.

**6. Abbreviations**

Not applicable.

**(Next printed page is 41)**

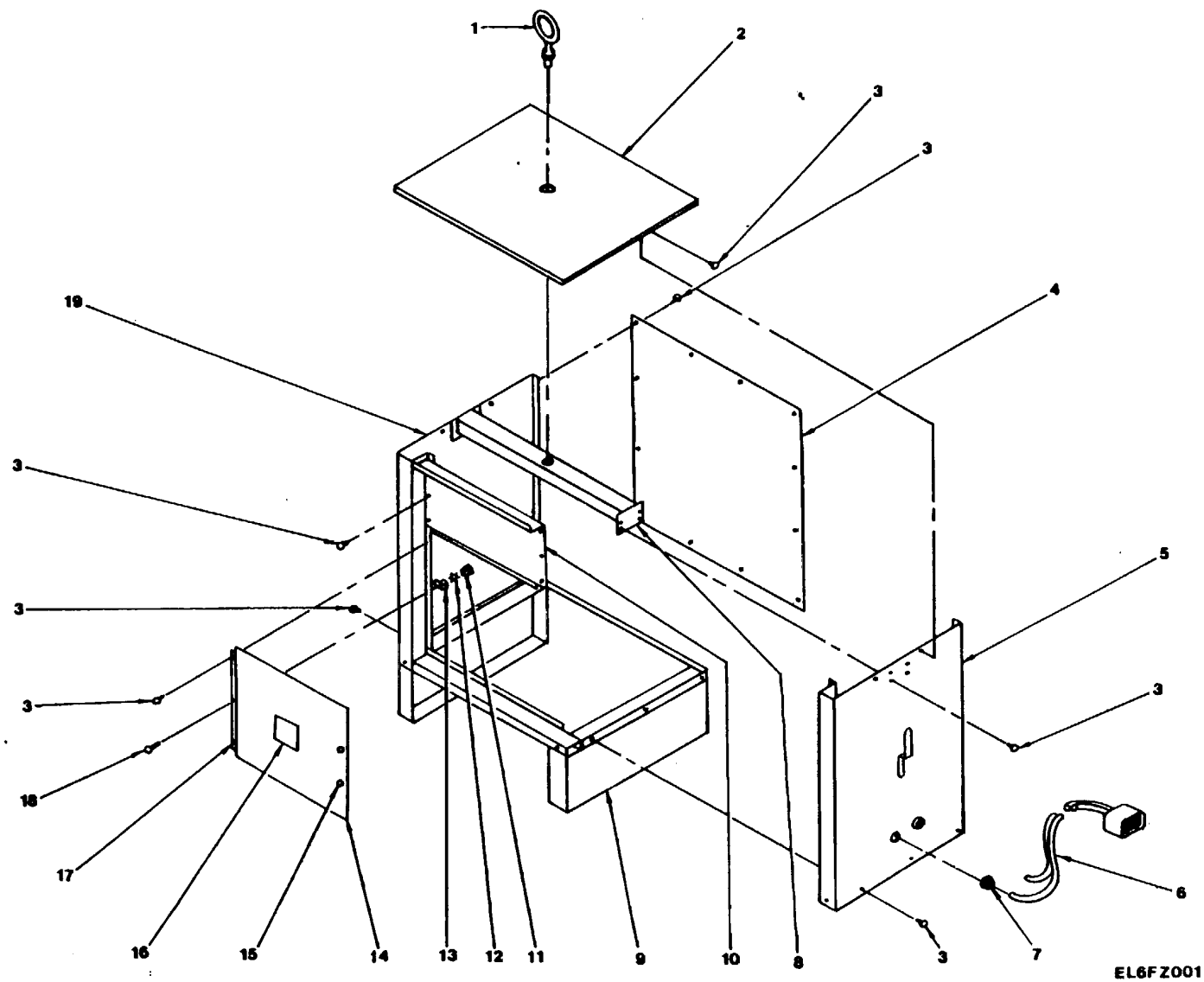

Figure 1. Charger, Battery PP-2926D/U (Sheet 1 of 6).

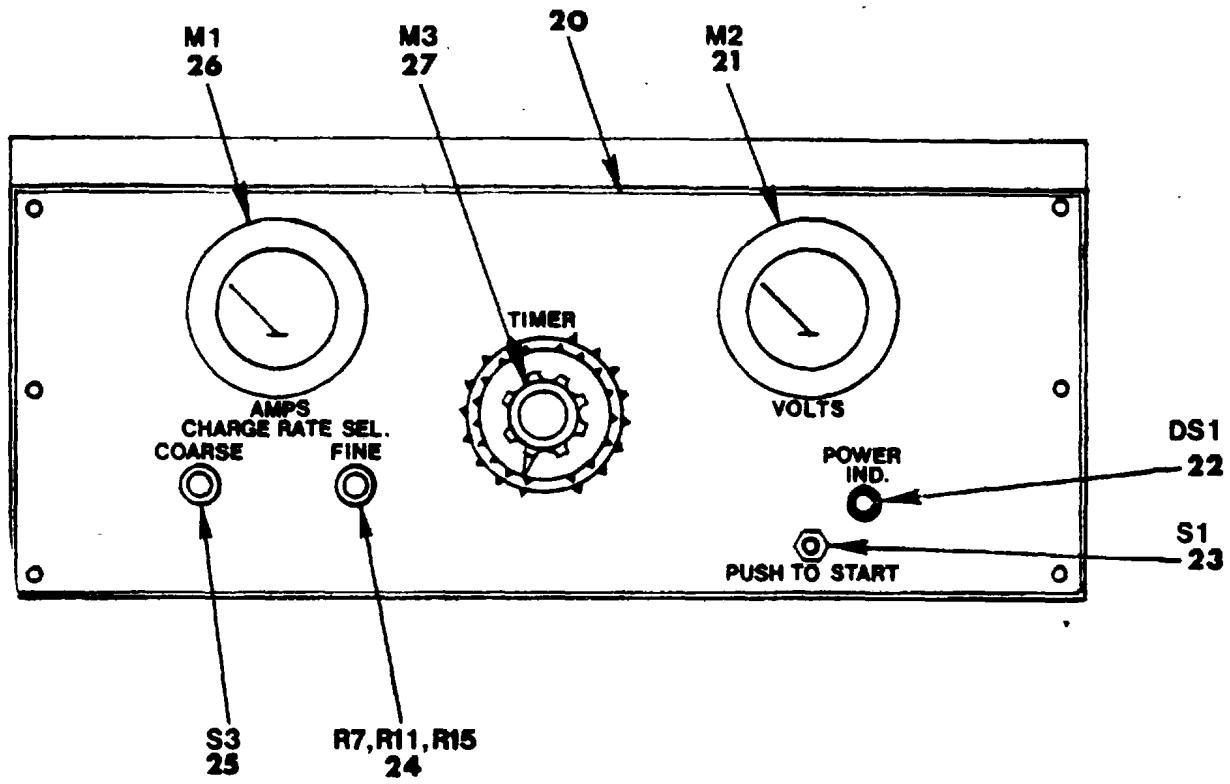
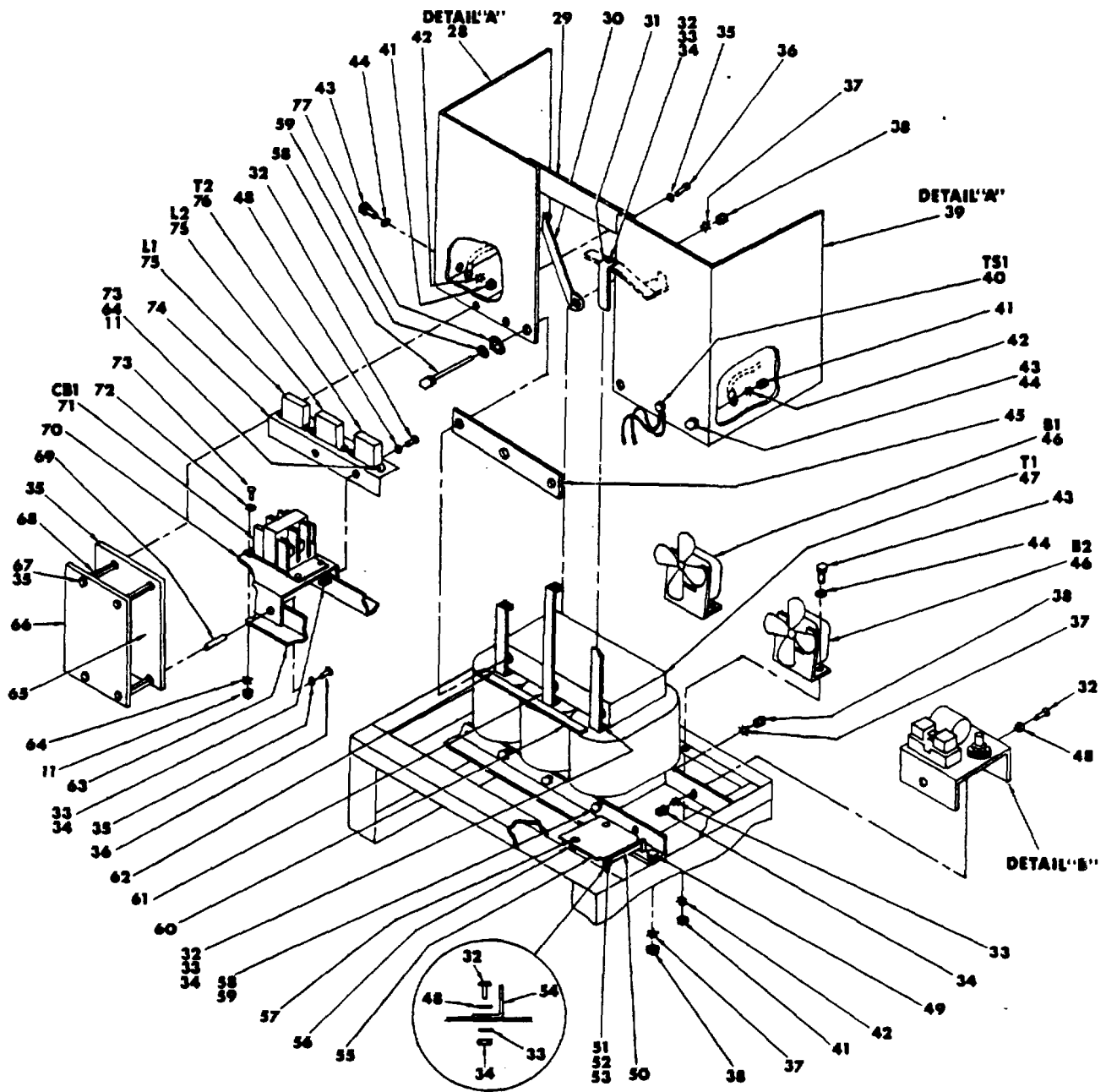

Figure 1. Charger, Battery PP-2926D/U (Sheet 2 of 6).

EL6FZ002





EL6FZ003

Figure 1. Charger, Battery PP-2926D/U (Sheet 3 of 6).

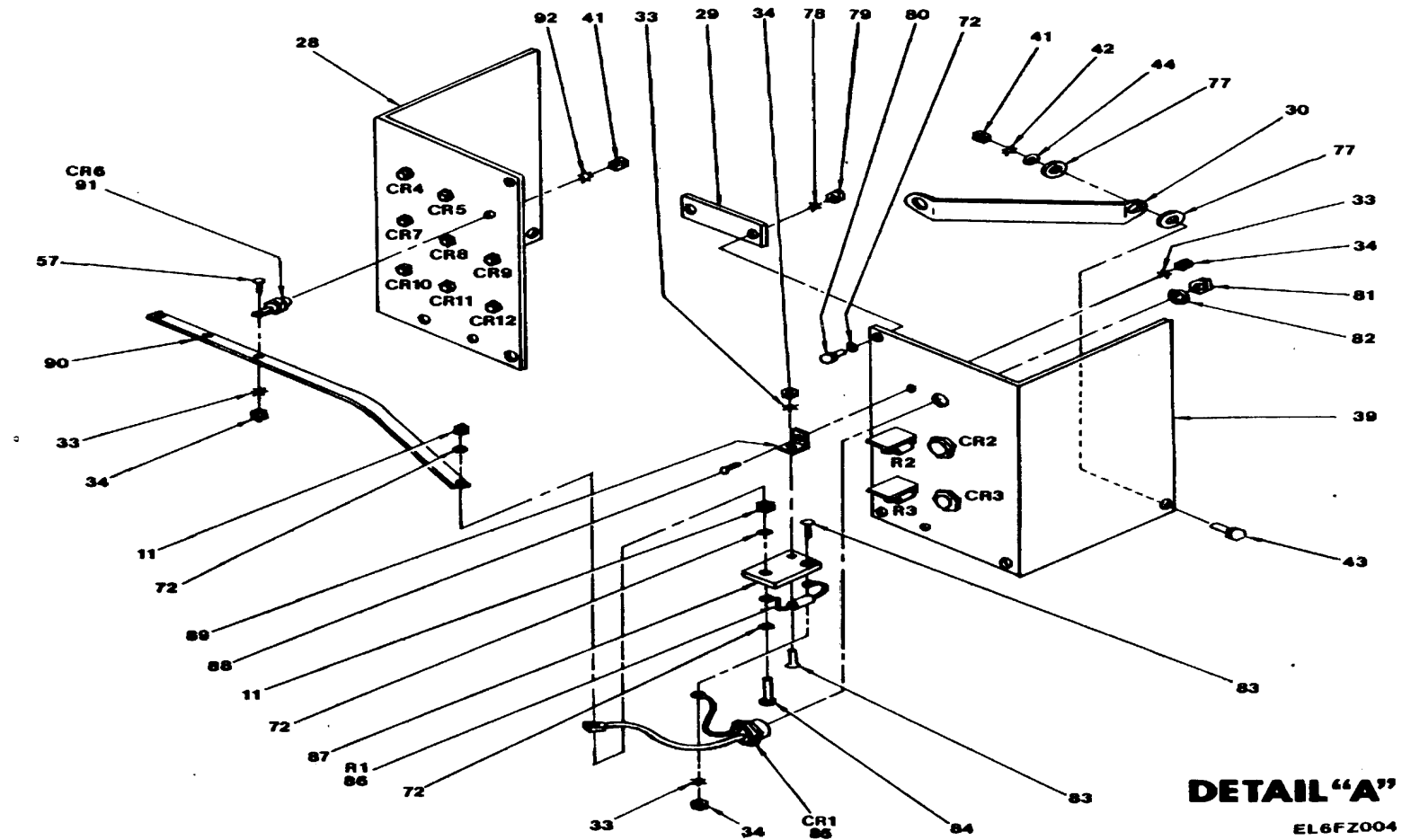

Figure 1. Charger, Battery PP-2926D/U (Sheet 4 of 6).

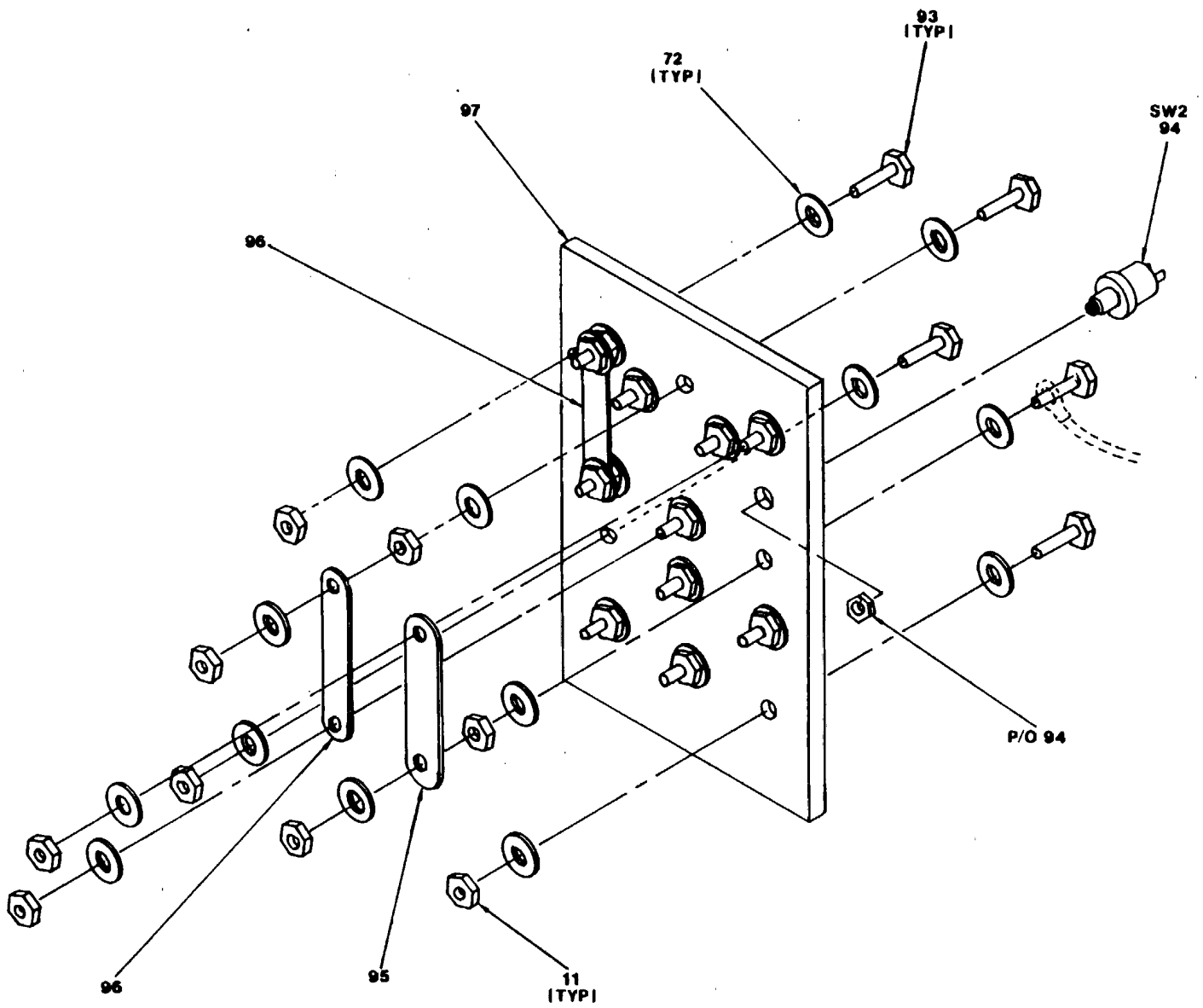
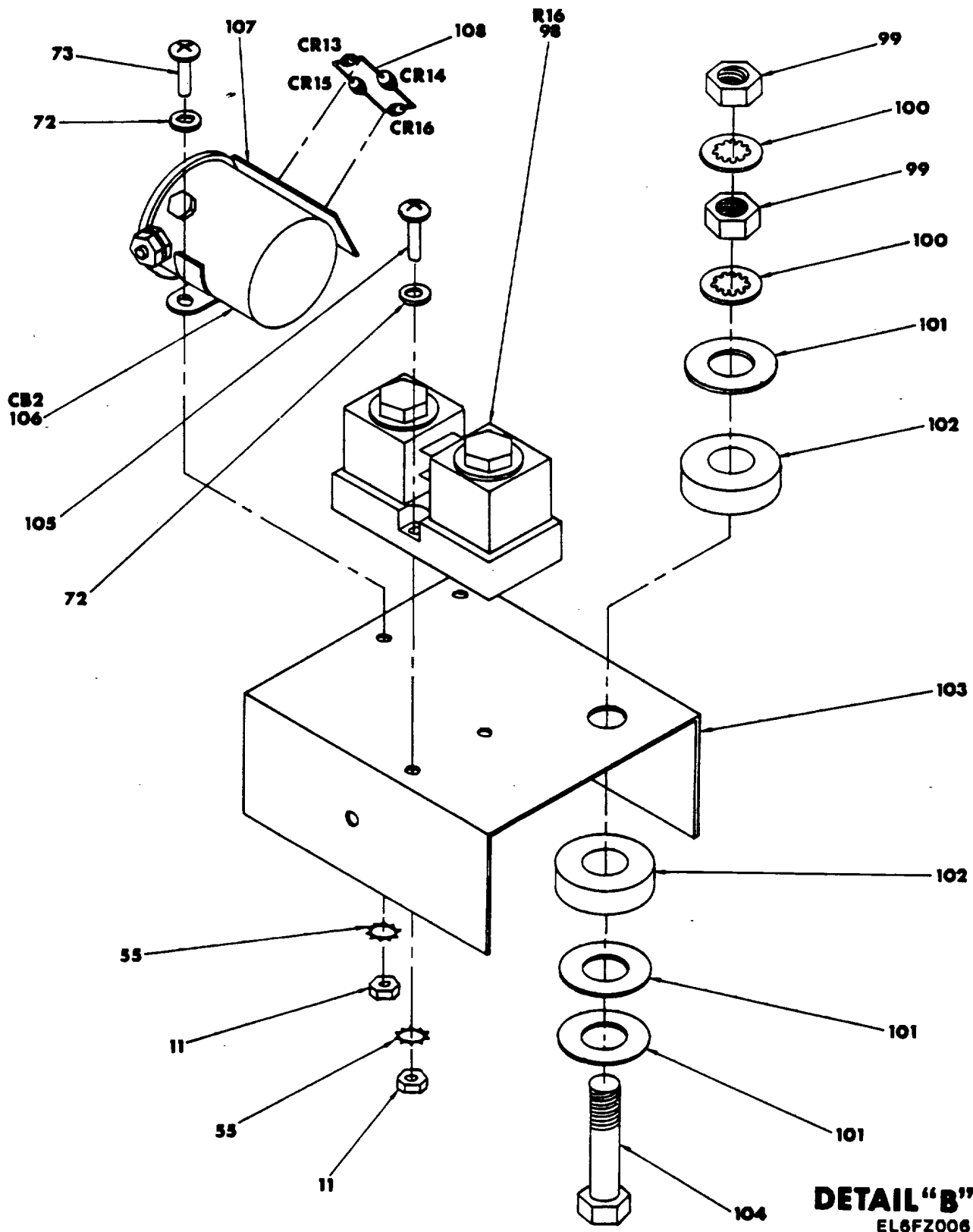

Figure 1. Charger, Battery PP-2926D/U (Sheet 5 of 6).

EL6FZ005



**DETAIL "B"**  
EL6FZ006

Figure 1. Charger, Battery PP-2926D/U (Sheet 6 of 6).

SECTION II

TM 11-6130-412-40P

(1) ILLUSTRATION		(2)	(3)	(4)	(5)	(6)	(7)	(8)
(a) FIG NO.	(b) ITEM NO.	SMR CODE	NATIONAL STOCK NUMBER	PART NUMBER	FSCM	DESCRIPTION  USABLE ON CODE	U/M	QTY INC IN UNIT
						GROUP 00 CHARGER.BATTERY PP-29260/U		
1	1	XDHZZ		10063-1	52512	RING,HOISTING .....	EA	1
1	2	XDHZZ		100620-1	52512	PNEL, TOP .....	EA	1
1	3	PAHZZ	5305-00-058-2102	MS24622-17	96906	SCREW,TAPPING. THREA .....	EA	40
1	4	XDHZZ		100621-1	52512	PANEL, REAR .....	EA	1
1	5	XDHZZ		100622-1	52512	PANEL,RIGHT SIDE .....	EA	1
1	6	PADZZ		100664-1	52512	CABLE, ASSEMBLY SPE .....	EA	1
1	7	PAHZZ	5325-00-174-9325	MS35489-107	96906	GROMMET,NONMETALLIC .....	EA	2
1	8	XDHZZ		100627-1	52512	BRACKET,SUPPORT .....	EA	1
1	9	XDHZZ		100623-1	52512	BASE, CABINET .....	EA	1
1	10	XDHHH		100661-1	52512	PANEL, ASSY, FRONT .....	EA	1
1	11	PAHZZ	5310-00-934-9759	MS35649-284	96906	NUT,PLAIN,HEXAGON .....	EA	48
1	12	PAHZZ	5310-00-614-3552	MS35335-59	96906	WASHER,LOCK .....	EA	1
1	13	PAHZZ	5340-00-570-8271	MS25281-8	96906	CLAMP,CABLE .....	EA	1
1	14	XDHZZ		100624-1	52512	SOOR,FRONT .....	EA	1
1	15	XDHZZ		85-14-100-16	94222	FASTENER,DZUS .....	EA	2
1	16	MDHZZ		100632-1	52512	PLATE,INDENT .....	EA	1
1	17	XDHZZ		MS20257-C3-1200	96906	HINGE .....	EA	1
1	18	PAHZZ	5305-00-054-6672	MS57957-47	96906	SCREW MACHINE .....	EA	1
1	19	XDHZZ		100625-1	52512	PANEL,LEFT SIDE .....	EA	1
1	20	XDHZZ		100626-1	52512	PANEL,FRONT .....	EA	1
1	21	PAHZZ		365-221	52512	VOLTMETER .....	EA	1
1	22	PAHZZ	6210-00-566-8142	2150A1	91802	LIGHT, INDICATOR .....	EA	1
1	23	PAHZZ		100595-1	52512	SWITCH, PUSH .....	EA	1
1	24	PAHZZ		KKKU2021R64	35627	RESISTOR,VARIABLE .....	EA	1
1	25	PAHZZ		100594-1	52512	SWITCH,ROTARY .....	EA	1
1	26	PAHZZ		365220	52512	METER,AMPHEERES-HOU .....	EA	1
1	27	PAHZZ		166-0001-01G	52512	TIMEER,INTERVAL .....	EA	1
1	28	XDHZZ		100629-1	52512	HEAT SINK LEFT .....	EA	1
1	29	XDHZZ		100651-1	52512	BRKT,HEATSINK SPRT .....	EA	1
1	30	XDHZZ		100652-1	52512	BRKT,HEATSINK MTG .....	EA	2
1	31	XFHZZ		100647-2	52512	STRAP XGMR CONN .....	EA	1
1	32	PAHZZ	5305-00-054-6654	MS51*57-30	96906	SCREW,MACHINE .....	EA	14
1	33	PAHZZ	5310-00-807-4795	MS35335-56	96906	WASHER,LOCK .....	EA	37
1	34	PAHZZ	5310-00-934-9761	MS35649-264	96906	NUT,PLAIN,HEXAGON .....	EA	29
1	35	XDHZZ	5310-00-619-1148	MS15795-808	96906	WASHER,FLAT .....	EA	6
1	36	PAHZZ	5305-00-059-366	MS51958-70	96906	SCREW,MACHINE .....	EA	4
1	37	PAHZZ	5310-00-184-9562	MS35335-62	96906	WASHER,LOCK .....	EA	10
1	38	PAHZZ	5310-00-252-8748	MS35650-3314	96906	NUT .....	EA	10
1	39	XDHZZ		100628-1	52512	HEATSINK,RIGHT .....	EA	1
					<b>5</b>			

## SECTION II

TM 11-6130-412-40P

(1) ILLUSTRATION		(2)	(3)	(4)	(5)	(6)	(7)	(8)
(a) FIG NO.	(b) ITEM NO.	SMR CODE	NATIONAL STOCK NUMBER	PART NUMBER	FSCM	DESCRIPTION  USABLE ON CODE	U/M	QTY INC IN UNIT
1	40	PAHZZ	5930-01-053-1506	2450-296-1	14604	SWITCH, THERMOSTATIC.....	EA	1
1	41	PAHZZ	5310-00-400-5503	MS35650-3254	96906	NUT,PLAIN,HEXAGON .....	EA	25
1	42	XDHZZ	5310-00-543-2740	MS35333-74	96906	WASHER,LOCK .....	EA	16
1	43	PAHZZ	5305-00-685-3511	MS35308-306	96906	SCREW,CAP,HEXAGON H .....	EA	16
1	44	PAHZZ	5310-00-582-5677	MS15795-810	96906	WASHER, FLAT .....	EA	24
1	45	XDHZZ		100662-1	52512	PLATE, INSULATING .....	EA	1
1	46	PAHZZ		100666-1	52512	FAN,CIRCULATING.....	EA	2
1	447	PAHZZ		100596-1B	52512	TRANSFORMER OWER.....	EA	1
1	48	PAHZZ	5310-00-880-5976	MS15795-806	96906	WASHER,FLAT .....	EA	4
1	49	PAHZZ	5306-00-0021-3912	MS35308-34	96906	BOLT,MACHINE .....	EA	4
1	50	PAHZZ		6AB04-35-201-00	80183	CONNECTOR PCB .....	EA	1
1	51	PAHZZ	5305-00-054-5651	MS51957-17	96906	SCREW, MACHINE .....	EA	2
1	52	PAHZZ	5310-00-933-8118	MS35338-135	96906	WASHER,LOCK .....	EA	2
1	53	PAHZZ	5310-00-934-9748	MS35649-244	96906	NUT,PLAIN,HEXAGON .....	EA	2
1	54	XDHZZ		100650-1	52512	BRKT, PCB CONN MTG .....	EA	2
1	55	PAHHHH		100657-1	52512	PRINTED CIRCUIT BO .....	EA	1
1	56	XDHZZ		100646-1	52512	BRKT PCB MTG .....	EA	1
1	57	PAHZZ	5305-00-054-6652	MS51957-28	96906	SCREW,MACHINE .....	EA	11
1	58	XDHZZ		MS35308-352	96906	SCREW, MACHINE .....	EA	6
1	59	PAHZZ	5310-00-625-5756	MS51795-812	96906	WASHER,FLAT .....	EA	18
1	60	XDHZZ		100647-1	52512	STRAP XGMR CONN .....	EA	1
1	61	XDHZZ		100647-3	52512	STRAP XFMR CONN .....	EA	1
1	62	XDHZZ		100647-4	52512	STRAP XFMR CONN .....	EA	1
1	63	XDHZZ		100630-1	52512	BRACKET XFMR CONN .....	EA	2
1	64	PAHZZ	5310-00-543-2739	MS35333-72	96906	WASHER, LOCK .....	EA	15
1	65	XDHHH		100658-1	52512	ASSY,TB .....	EA	1
1	66	XDHZZ		100591-1A	52512	COVER TB .....	EA	1
1	67	PAHZZ	5305-00-059-3659	MS51958-63	96906	SCREW, MACHINE .....	EA	4
1	68	XDHZZ		100648-2	52512	STANDOFF .....	EA	4
1	69	XDHZZ		100648-1	52512	STANDOFF .....	EA	4
1	70	XDHZZ		100644-1	52512	PLATE,LEFT CHASSIS .....	EA	1
1	71	PAHZZ		100640-1	52512	CIRRCUIT BREAKER .....	EA	1
1	72	PAHZZ	5310-00-880-5978	MS175795-807	96906	WASHER,FLAT .....	EA	59
1	73	PAHZZ	5305-00-054-6670	MS51957-45	96906	SCREW,MACHINE .....	EA	12
1	74	XDHZZ		100653-1	52512	BRACKET IND MTG .....	EA	1
1	75	PAHZZ		100592-1	52512	TRANSFORMER POWER .....	EA	1
1	76	PAHZZ		100593-1	52512	INDUCTION STANDARD .....	EA	2
1	77	SDHZZ		100631-1	52512	WASGER, INSSULATING.....	EA	6
1	78	PAHZZ	5310-00-543-5933	MS35333-73	96906	WASHER,LOCK .....	EA	2
1	79	PAHZZ	5310-00-934-9765	MS35650-304	96906	NUT PLAIN,HEXAGON .....	EA	6
					<b>6</b>			

SECTION II

TM 11-6130-412-40P

(1) ILLUSTRATION		(2)	(3)	(4)	(5)	(6)	(7)	(8)
(a) FIG NO.	(b) ITEM NO.	SMR CODE	NATIONAL STOCK NUMBER	PART NUMBER	FSCM	DESCRIPTION  USABLE ON CODE	U/M	QTY INC IN UNIT
1	80	PAHZZ	5305-00-059-3657	MS51958-61	96906	SCREW,MACHINE .....	EA	2
1	81	PAHZZ	5310-00-488-9327	MS35650-3394	96906	NUT,PLAIN,HEXAGON .....	EA	3
1	82	PAHZZ	5310-00-261-7156	MS35333-78	96906	WASHER, LOCK .....	EA	3
1	83	PAHZZ	5305-00-719-5064	MS51959-30	96906	SCREW,MACHINE .....	EA	6
1	84	PAHZZ	5305-00-764-0075	MS51959-49	96906	SCREW,MACHINE .....	EA	3
1	85	PAHZZ	2N2025	09214		SEMICONDUCTOR DEVI.....	EA	3
1	86	PAHZZ	5905-00-173-1119	RCR42G151JS	81349	RESISTOR,FIXED,COMP .....	EA	3
1	87	XDHZZ		100641-1	52512	BLOCK,INSULATION .....	EA	3
1	88	PAHZZ	5305-00-054-6668	MS57957-43	96906	SCREW,MACHINE .....	EA	3
1	89	XDHZZ		100642-1	52512	BRACKET MTG .....	EA	3
1	90	XDHZZ		100649-1	52512	STRAP,DIODE CONN .....	EA	3
1	91	PAHZZ		1N2129	09214	DIODE .....	EA	9
1	92	PAHZZ	5310-00-527-3634	MS35335-61	96906	WASHER,LOCK .....	EA	9
1	93	PAHZZ	5305-00-054-6674	MS51957-49	96906	SCREW,MACHINE .....	EA	15
1	94	PAHZZ	5930-00-241-3547	MSP103C	95146	SWITCH,PUSH.....	EA	1
1	95	XDHZZ		100660-1	52512	BAR,SHORTING .....	EA	1
1	96	XDHZZ		100659-1	52512	BAR,SHORTING .....	EA	2
1	97	XDHZZ		100591-1	52512	BOARD,TERMINAL .....	EA	1
1	98	XDHZZ		872-975	52512	SHUNT .....	EA	1
1	99	PAHZZ	5310-00-245-3612	MS35650-3384	96906	NUT PLAIN, HEXAGON .....	EA	2
1	100	PAHZZ	5310-00-180-0277	MS35333-76	96906	WASHER,LOCK .....	EA	2
1	101	PAHZZ	5310-00-773-7618	MS15795-814	96906	WASHER,FLAT .....	EA	3
1	102	XDHZZ		100645-1	52512	BUSHING,INSULATIN .....	EA	2
1	103	XDHZZ		100643-1	52512	PLATE,RIGHT CHASSIS.....	EA	1
1	104	5305-00-801-1290		MS35308-366	96906	SCREW,CAP,HEXAGON H .....	EA	1
1	105	PAHZZ	5305-00-054-6671	MS51957-46	96906	SCREW,MACHINE .....	EA	2
1	106	PAHZZ	5945-00-521-0204	70-901	80089	SOLENOID,ELECTRICAL .....	EA	1
1	107	XDHHH		100603-1	52512	RECT BRIDGE ASSY .....	EA	1
1	108	PAHZZ	5961-00-977-8021	1N4006	09214	SEMICONDUCTOR DEVIC.....	EA	4
					7			

18

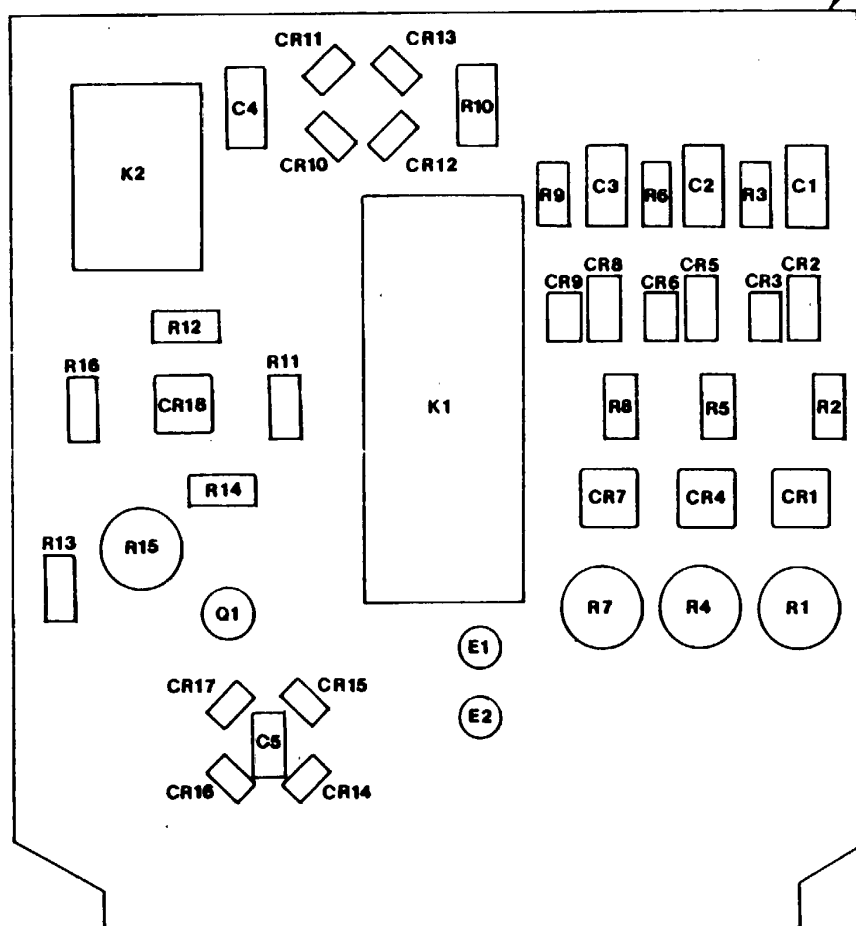

**LEGEND**

REF DES	ITEM NO	REF DES	ITEM NO
CR1	1	C5	5
CR2	2	E1	6
CR3	3	E2	6
CR4	1	K1	7
CR5	2	K2	8
CR6	3	Q1	9
CR7	1	R1	10
CR8	2	R2	11
CR9	3	R3	12
CR10	3	R4	10
CR11	3	R5	11
CR12	3	R6	12
CR13	3	R7	10
CR14	3	R8	11
CR15	3	R9	12
CR16	3	R10	13
CR17	3	R11	14
CR18	1	R12	15
C1	4	R13	15
C2	4	R14	16
C3	4	R15	17
C4	4	R16	14

**NOTE: PREFIX ALL REFERENCE DESIGNATIONS WITH A1**

EL6FZ007

Figure 2. Printed Circuit Board AI.



SECTION II

TM 11-6130-412-40P

(1) ILLUSTRATION		(2)	(3)	(4)	(5)	(6) DESCRIPTION	(7)	(8)
(a) FIG NO.	(b) ITEM NO.	SMR CODE	NATIONAL STOCK NUMBER	PART NUMBER	FSCM	USABLE ON CODE	U/M	QTY INC IN UNIT
						<b>GROUP 01 PRINTED CIRCUIT BOARD A1</b>		
2	1	PAHZZ		1R16084	81483	SEMICONDUCTOR DEVI.....	EA	4
2	2	PAHZZ		N457	09214	DIODE .....	EA	3
2	3	PAHZZ	5961-00-977-8021	1N4006	09214	SEMICONDUCTOR DEVIC .....	EA	11
2	4	PAHZZ		100597-1	52512	CAPACITOR, FIXED .....	EA	4
2	5	PAHZZ		MEIJ001	84171	CAPACITOR, FIXED .....	EA	1
2	6	PAHZZ		100600-1	52512	SENSOR, TEMPERATURE .....	EA	2
2	7	PAHZZ		CR2TN1010	71482	RELAY .....	EA	1
2	8	PAHZZ		NF2-24V	09026	RELAY .....	EA	1
2	9	PAHZZ		2N4248	02763	TRANSISTOR.....	EA	1
2	10	PAHZZ		179-000-500	84048	RESISTOR, VARIABLE .....	EA	3
2	11	PAHZZ	5905-00-108-6922	RCR20G151JR	81349	RESISTOR, FIXED, COMP .....	EA	3
2	12	PAHZZ	5905-00-141-1118	RCR20G390JR	81349	RESISTOR, FIXED, COMP .....	EA	3
2	13	PAHZZ	5905-00-228-6088	RCR32G331JS	81349	RESISTOR, FIXED, COMP .....	EA	1
2	14	PAHZZ	5905-00-497-1271	RCR07G102JR	81349	RESISTOR, FIXED, COMP .....	EA	2
2	15	PAHZZ	5905-00-141-1130	RCR20G272JS	81349	RESISTOR, FIXED, COMP .....	EA	2
2	16	PAHZZ	5905-00-141-1168	RCR0G222JR	81349	RESISTOR, VARIABLE .....	EA	1
2	17	PAHZZ		179-00-5K	84048	RESISTOR, VARIABLE .....	EA	1
2	18	XAHZZ		4543-2	52512	PRINTED CIRCUIT BD.....	EA	1
					<b>9</b>			

NATIONAL STOCK NUMBER AND PART INDEX

STOCK NUMBER	FIG. NO.	ITEM NO.	STOCK NUMBER	FIG. NO.	ITEM NO.
5306-00-021-3912	1	49	5905-00-491-1271	2	14
5305-00-054-5651	1	51	5945-00-521-0204	1	106
5305-00-054-6652	1	57	53L0-00-527-3634	1	92
5305-00-054-6654	1	32	5310-00-543-2739	1	164
5305-00-054-6668	1	8a	5310-00-543-2740	1	42
5305-00-054-6670	1	73	53L0-00-543-5933	1	78
5305-00-054-6671	1	05	6210-00-566-8142	1	22
5305-00-054-6671	1	8	5340-00-570-8271	1	13
5305-00-054-6674	1	93	5310-00-582-5677	1	44
5305-00-058-2102	1	3	5310-00-614-3552	1	12
5305-00-059-3657	1	80	5310-00-619-1148	1	35
5305-00-059-3659	1	67	5310-00-625-5756	1	59
5305-00-059-3666	1	36	5305-00-685-3511	1	43
5905-00-110-6922	2	11	5305-00-719-5064	1	83
5905-00-141-1118	2	12	5305-00-764-0075	1	84
5905-00-141-1130	2	5	5310-00-773-7615	1	101
5905-00-141-1168	2	16	5305-00-801-1290	1	104
5905-00-173-1119	1	86	5310-00-807-4795	1	33
5325-00-174-9325	1	7	5310-00-880-5976	1	48
5310-00-180-0277	1	100	5310-00-880-597S	1	72
5310-00-184-9562	1	37	5310-00-933-8118	1	52
5905-00-228-6088	2	13	5310-00-934-9748	1	53
5930-00-241-3547	1	94	5310-00-934-9759	1	11
5310-00-245-3612	1	99	5310-00-934-9761	1	34
5310-00-252-8748	1	38	5310-00-934-9765	1	79
5310-00-261-7156	1	82	5961-00-977-8021	1	10
5310-00-400-5503	1	41	5961-00-977-8021	2	3
5310-00-488-9327	1	81	5930-01-053-1506	1	40

PART NUMBER	FSCM	FIG. NO.	ITEM NO.	PART NUMBER	FSCM	FIG. NO.	ITEM NO.
CRZTN1010	71482	2	7	M551959-30	96906	1	83
KKK02021R64	35627	1	24	MS51959-49	96906	1	84
ME1J001	84171	2	5	NF2-24V	09026	2	8
MSP103C	951L6	1	94	R07C10RGL2JR	81349	2	14
MS15795-806	96906	1	48	RCR2OGI5JR	81349	2	11
MSI5795-807	96906	1	72	ICR2OG222JR	81349	2	16
M515795-808	so906	1	35	RCR2OG22JS	81349	2	15
MS17595-810	96906	1	44	RCR2OG39OJR	81349	2	12
MS15795-812	96906	1	59	RCR32G33LJ5	81349	2	13
MS15795-814	96906	1	101	RCR42GL1sJS	81349	1	86
MS20257-C3-1200	96906	1	17	1N12129	09214	1	91
MS24622-17	96906	1	3	1N4006	09214	1	108
MS25281-8	96906	1	13	1N4006	09214	2	3
MS35308-306	96906	1	43	1N457	09214	2	2
MS35308-334	6906	1	49	1R10684	81483	2	1
MS53308-352	96906	1	58	100591-1	52512	1	97
MS35308-366	96906	1	104	100591-1A	52512	1	66
MS35333-72	96906	1	64	100592-1	52512	1	75
MS35333-13	96906	1	78	130593-1	52512	1	76
MS35333-74	9s906	1	42	100594-1	52512	1	25
MS35333-76	96906	1	100	100595-1	52512	1	23
MS35333-78	96906	1	82	100596-18	52512	1	47
MS35335-56	96906	1	33	100597-1	52512	2	4
MS35335-59	96906	1	12	100600-1	52512	2	6
MS35335-61	96906	1	92	100603-1	52512	1	107
MS35335-62	96906	1	37	100620-1	52512	1	2
MS535339-135	96906	1	52	100621-1	52512	1	4
MS35489-107	96906	1	7	100622-1	52512	1	5
MS35649-244	96906	1	53	100623-1	52512	1	9
M535649-264	96906	1	34	100624-1	52512	1	14
MS35649-284	96906	1	11	100625-1	52512	1	19
MS35650-304	96906	1	79	100626-1	52512	1	20
MS35650-3254	96906	1	41	100627-1	52512	1	8
MS35650-3314	96906	1	38	100628-L	52512	1	39
MS35650-3384	96906	1	99	100629-1	52512	1	28
MS35650-3394	96906	1	81	100630-1	52512	1	63
MS51957-17	96906	1	51	100631-1	52512	1	77
MS51957-28	96906	1	57	100632-1	52512	1	16
MS51957-30	96906	1	32	100640-1	52512	1	71
MS51957-43	96906	1	88	100641-1	52512	1	87
MS51957-45	96906	1	73	100642-1	52512	1	89
MS51957-46	96906	1	105	100643-1	52512	1	103
MS51957-47	96906	1	18	100644-1	52512	1	70
MS51957-49	96906	1	93	100645-1	52512	1	102
MS51958-61	96906	1	80	100646-1	52512	1	56
MS51958-63	96906	1	67	100647-1	52512	1	60
MS51958-70	96906	1	36	100647-2	52512	1	31

## SECTION IV

TM 11-6130-412-40P

## NATIONAL STOCK NUMBER AND PART INDEX

PART NUMBER	FSCM	FIG. NO.	ITEM NO.	PART NUMBER	FSCM	FIG. NO.	ITEM NO.
100647-3	52512	1	61	10066-1	52512	1	6
100647-4	52512	1	62	10066-1	52512	1	46
100648-1	52512	1	69	166-0001-01G	52512	1	27
100648-2	52512	1	68	119-000-5K	84048	2	17
100649-1	52512	1	90	119-000-500	86048	2	10
100650-1	52512	1	54	2N2025	09214	1	85
100651-1	52512	1	29	2N42468	02163	2	9
100652-1	52512	1	30	2150A1	91802	1	22
100653-1	52512	1	71	2450-296-1	14604	1	40
100657-1	52512	1	55	365-221	52512	1	21
100658-1	52512	1	65	365220	52512	1	26
100659-1	52512	1	96	4543-2	52512	2	18
100660-1	52512	1	95	6AB4-35-2D1-00	80183	1	50
100661-1	52512	1	10	70-901	80089	1	106
100662-1	52512	1	65	85-14-100-16	94222	1	15
100663-1	52512	1	1	812-915	52512	1	98

11/(12 BLANK)

\*U.S. GOVERNMENT PRINTING OFFICE: 1990 703-029/370

By Order of the Secretary of the Army:

E. C. MEYER  
General, United States Army  
Chief of Staff

Official:

J. C. PENNINGTON  
Major General, United States Army  
The Adjutant General

DISTRIBUTION:

Active Army:

HISA (Ft Monmouth) (21)  
USAINSCOM (2)  
COE (1)  
TSG (1)  
USAARENBD (1)  
DARCOM (1)  
TRADOC (2)  
OS Maj Comd (4)  
TECOM (2)  
USACC (4)  
MDW (1)  
Armies (2)  
Corps (2)  
Svc Colleges (1)  
USASIGS (5)  
USAADS (2)  
USAFAS (2)  
USAARMS (2)  
USAIS (2)

USAES (2)  
USAICS (3)  
MAAG (1)  
USARMIS (1)  
USAERDAA (1)  
USAERDAW (1)  
Fort Gordon (10)  
Fort Carson (5)  
Army Dep (1) except  
    SAAD (30)  
    TOAD (14)  
    SHAD (2)  
Ft Gillem (10)  
USA Dep (1)  
Sig Sec USA Dep (1)  
Fort Richardson (CERCOM Ofc) (2)  
Units org under fol TOE:  
    29-207 (2)  
    29-610 (2)

NG: State AG (3)

USAR: None

For explanation of abbreviations used, see AR 310-50.

RECOMMENDED CHANGES TO EQUIPMENT TECHNICAL PUBLICATIONS



THEN...JOT DOWN THE  
DOPE ABOUT IT ON THIS FORM.  
CAREFULLY TEAR IT OUT, FOLD IT  
AND DROP IT IN THE MAIL.

SOMETHING WRONG WITH PUBLICATION

FROM: (PRINT YOUR UNIT'S COMPLETE ADDRESS)

DATE SENT

PUBLICATION NUMBER

PUBLICATION DATE

PUBLICATION TITLE

BE EXACT PIN-POINT WHERE IT IS

PAGE  
NO.

PARA-  
GRAPH

FIGURE  
NO.

TABLE  
NO.

IN THIS SPACE, TELL WHAT IS WRONG  
AND WHAT SHOULD BE DONE ABOUT IT.

TEAR ALONG PERFORATED LINE

PRINTED NAME, GRADE OR TITLE AND TELEPHONE NUMBER

SIGN HERE

# THE METRIC SYSTEM AND EQUIVALENTS

## WEIGHT MEASURE

1 Centimeter = 10 Millimeters = 0.01 Meters = 0.3937 Inches  
 1 Meter = 100 Centimeters = 1000 Millimeters = 39.37 Inches  
 1 Kilometer = 1000 Meters = 0.621 Miles

## WEIGHTS

1 Gram = 0.001 Kilograms = 1000 Milligrams = 0.035 Ounces  
 1 Kilogram = 1000 Grams = 2.2 lb.  
 1 Metric Ton = 1000 Kilograms = 1 Megagram = 1.1 Short Tons

## LIQUID MEASURE

1 Milliliter = 0.001 Liters = 0.0338 Fluid Ounces  
 1 Liter = 1000 Milliliters = 33.82 Fluid Ounces

## SQUARE MEASURE

1 Sq. Centimeter = 100 Sq. Millimeters = 0.155 Sq. Inches  
 1 Sq. Meter = 10,000 Sq. Centimeters = 10.76 Sq. Feet  
 1 Sq. Kilometer = 1,000,000 Sq. Meters = 0.386 Sq. Miles

## CUBIC MEASURE

1 Cu. Centimeter = 1000 Cu. Millimeters = 0.06 Cu. Inches  
 1 Cu. Meter = 1,000,000 Cu. Centimeters = 35.31 Cu. Feet

## TEMPERATURE

$5/9(^{\circ}\text{F} - 32) = ^{\circ}\text{C}$   
 212° Fahrenheit is equivalent to 100° Celsius  
 90° Fahrenheit is equivalent to 32.2° Celsius  
 32° Fahrenheit is equivalent to 0° Celsius  
 $9/5^{\circ}\text{C} + 32 = ^{\circ}\text{F}$

## APPROXIMATE CONVERSION FACTORS

TO CHANGE	TO	MULTIPLY BY
Inches	Centimeters	2.540
Feet	Meters	0.305
Yards	Meters	0.914
Miles	Kilometers	1.609
Square Inches	Square Centimeters	6.451
Square Feet	Square Meters	0.093
Square Yards	Square Meters	0.836
Square Miles	Square Kilometers	2.590
Acres	Square Hectometers	0.405
Cubic Feet	Cubic Meters	0.028
Cubic Yards	Cubic Meters	0.765
Fluid Ounces	Milliliters	29.573
its	Liters	0.473
arts	Liters	0.946
allons	Liters	3.785
Ounces	Grams	28.349
Pounds	Kilograms	0.454
Short Tons	Metric Tons	0.907
Pound-Feet	Newton-Meters	1.356
Pounds per Square Inch	Kilopascals	6.895
Miles per Gallon	Kilometers per Liter	0.425
Miles per Hour	Kilometers per Hour	1.609

TO CHANGE	TO	MULTIPLY BY
Centimeters	Inches	0.394
Meters	Feet	3.280
Meters	Yards	1.094
Kilometers	Miles	0.621
Square Centimeters	Square Inches	0.155
Square Meters	Square Feet	10.764
Square Meters	Square Yards	1.196
Square Kilometers	Square Miles	0.386
Square Hectometers	Acres	2.471
Cubic Meters	Cubic Feet	35.315
Cubic Meters	Cubic Yards	1.308
Milliliters	Fluid Ounces	0.034
Liters	Pints	2.113
Liters	Quarts	1.057
ers	Gallons	0.264
ms	Ounces	0.035
ograms	Pounds	2.205
Metric Tons	Short Tons	1.102
Newton-Meters	Pounds-Feet	0.738
Kilopascals	Pounds per Square Inch	0.145
ometers per Liter	Miles per Gallon	2.354
ometers per Hour	Miles per Hour	0.621



**PIN: 047482-000**